

Little Milton Village Hall

The Oxfordshire village of Little Milton has a new village hall which is helping this rural community flourish by providing an ideal venue for a variety of events.

The Client

Little Milton is the epitome of a typical English village. Set in beautiful countryside ten miles south of Oxford, at its heart it has a number of thatched stone cottages set around a church, pub and village school. Residents have a strong community spirit so when its village hall became outdated and in need of structural repair it was decided to replace it.

The Brief

The new hall should be built in a traditional manner, able to withstand hard use and flexible enough to stage a variety of functions and community events. It had to have a capacity of 150 seated in conference style, kitchen, changing rooms and toilets. An adjacent pre-school nursery was a timber lodge, so this style of building was preferred.

The Specification

A scheme was submitted to The Village Hall Association but this was little more than a 'log box' – it was felt that a more elegant design was required. Several companies who specialise in timber buildings were contacted with the proposal submitted by Pinelog being selected.

The new village hall is a traditional log effect building with two full height dormers and a vaulted ceiling. Large glazed doors and windows in the dormers make optimum use of natural

light to create a light airy feel. Changing rooms with showers, toilets, baby changing facilities and a kitchen are located at either side of the main hall.

The highly insulated building is of pressure treated redwood half-round log construction with Rockwool insulating batts, vapour control layers and a timber/plaster board internal wall lining. This form of construction provides a natural external appearance and ensures that the interior is cool in summer, warm in winter and sound insulated.

The roof is constructed from a glue laminated timber framework clad in green concrete shingles to match the adjacent nursery.

The hall is disabled compliant so that those with mobility difficulties have no problem entering or moving around and a disabled changing room, shower, toilet and ramps at the entrances have been included.





Client Benefits

Stuart McGill, Chairman of Little Milton Parish Council says: "The fact that Pinelog was able to combine their skills to provide a complete turnkey solution was a tremendous benefit for us. Their handling of detailed design, project management, organisation of site works, landscaping and liaison with all relevant planning committees meant this project went through smoothly and without a hitch."

Now called The Pine Lodge, the hall is a registered charity. The £280,000 cost was funded by grants from South Oxfordshire District Council, WREN and Defra. So successful has it been that it was selected by South East Rural Community Councils as the subject of a DVD 'How to build a village hall.' This will be distributed to rural communities showing them how to fund, build and run a hall to help their community flourish.

Stuart McGill concludes: "We are delighted. Pinelog has given the village a facility second to none. It is an ideal venue for a variety of functions and enjoys great popularity with residents of this and surrounding villages. It is a resounding success – many thanks for giving us a splendid building."

Client: Little Milton Village Hall Association
 Location: Little Milton, Oxfordshire

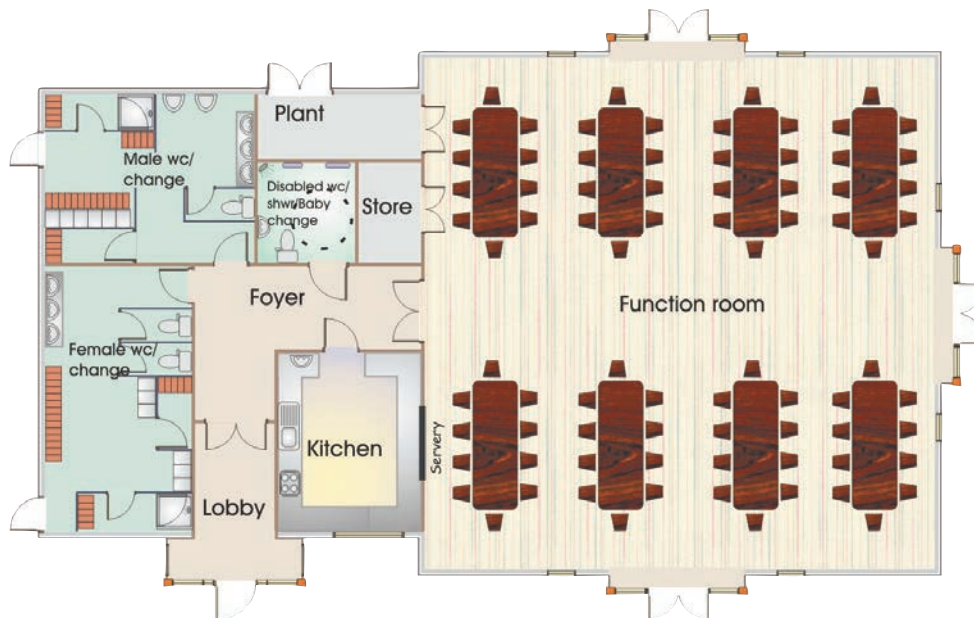

Pinelog Limited, Riverside Business Park, Bakewell, Derbyshire DE45 1GS
 Tel: 01629 814481 Fax: 01629 814634
 email: admin@pinelog.co.uk www.pinelog.co.uk